

NAUGATUCK AVENUE DRAINAGE IMPROVEMENTS  
STP-URBAN / STATE PROJECT #83-262  
NAUGATUCK AVENUE AND CHURCH STREET  
MILFORD, CONNECTICUT

REVISIONS  
No. 1  
Date 03/09/15  
Description ISSUED FOR BIDDING

Designed R.B.  
Drawn J.B.  
Checked  
Approved  
Scale 1"=40'  
Project No. OBC3036  
Date 3/09/2015

CAD File: TMPT08C303601

Title MAINTENANCE  
AND PROTECTION  
OF TRAFFIC PLAN  
(PHASE 1)

Sheet No.

MPT-1

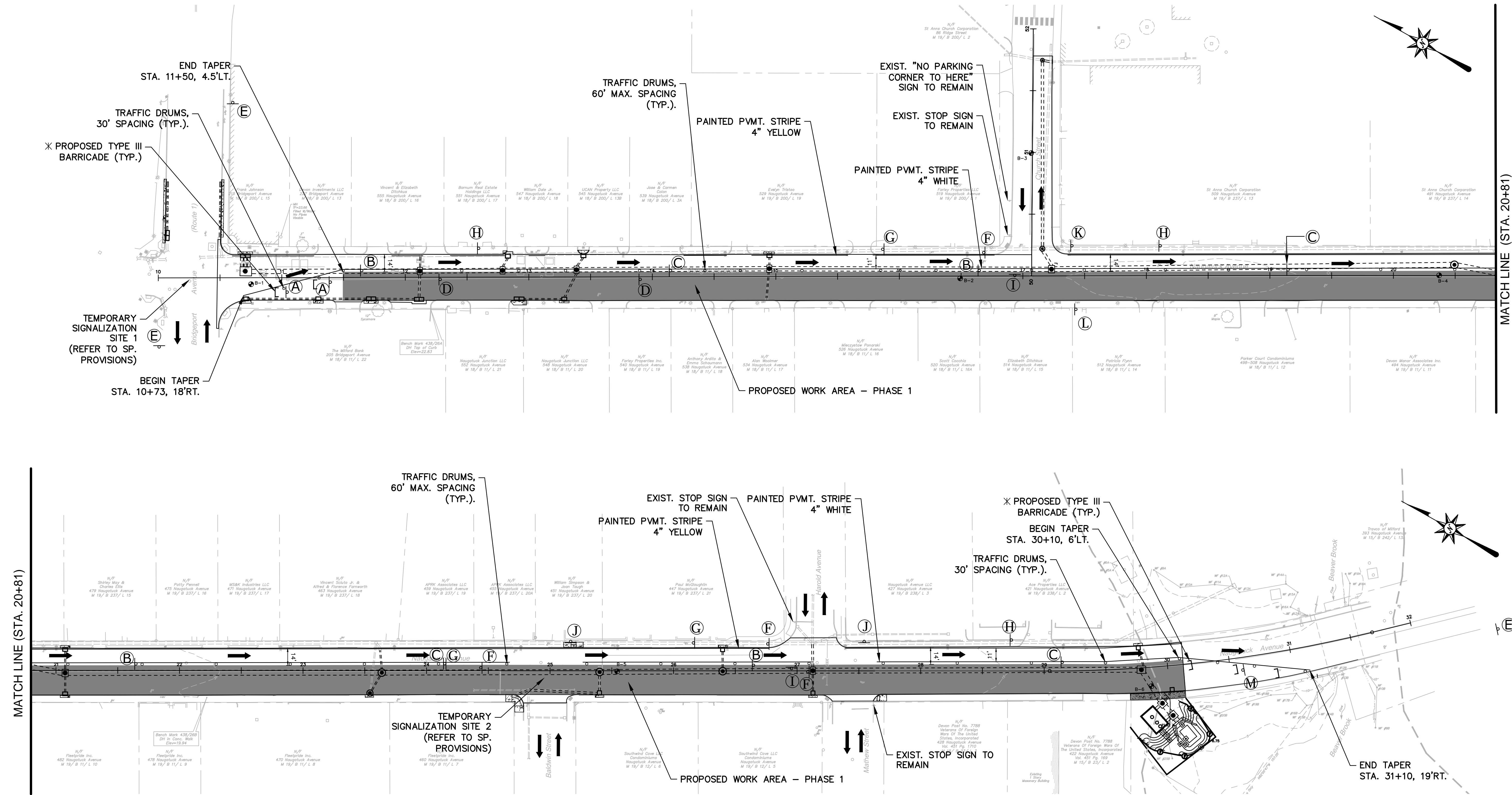

LEGEND

SYMBOL	DESCRIPTION	CONN D.O.T. NO.	AREA (SF)
(A)		80-9422L	4.5 SF
(B)	*	80-9959	16 SF
(C)	*	80-9951	16 SF
(D)		80-4601	6 SF
(E)		80-9612	8 SF

\* BARRICADE WARNING LIGHTS-HIGH INTENSITY

(F)		31-1119	6.25 SF
(G)		31-1122	6 SF
(H)		31-5505	5 SF
(I)	(L)	31-1188	3 SF
(J)	(R)	31-1177	3 SF

(K)		31-0630	2 SF
(L)		80-9075	2 SF
(M)		80-9080	10 SF
(O)	TEMPORARY TRAFFIC DRUMS	-	-
(P)	DIRECTION OF TRAFFIC	-	-
(Q)	CONSTRUCTION SIGN (TYP.)	-	-
(R)	PROPOSED WORK AREA	-	-

GENERAL NOTES

- CONTRACTOR SHALL MOVE ALL NECESSARY SIGNAGE AND TRAFFIC BARRIERS TO THE APPROPRIATE LOCATION WHEN COMPLETING PHASED CONSTRUCTION TO ALLOW FOR VEHICULAR ACCESS TO AND FROM PRIVATE RESIDENCES AND BUSINESSES TO THROUGHOUT THE LENGTH OF THE PROJECT.
- REFER TO SHEET NO. GN-1 FOR M&PT NOTES.

